

FRONT DANA-30 WITH DISCONNECT

H31

AXLE & DIFFERENTIAL

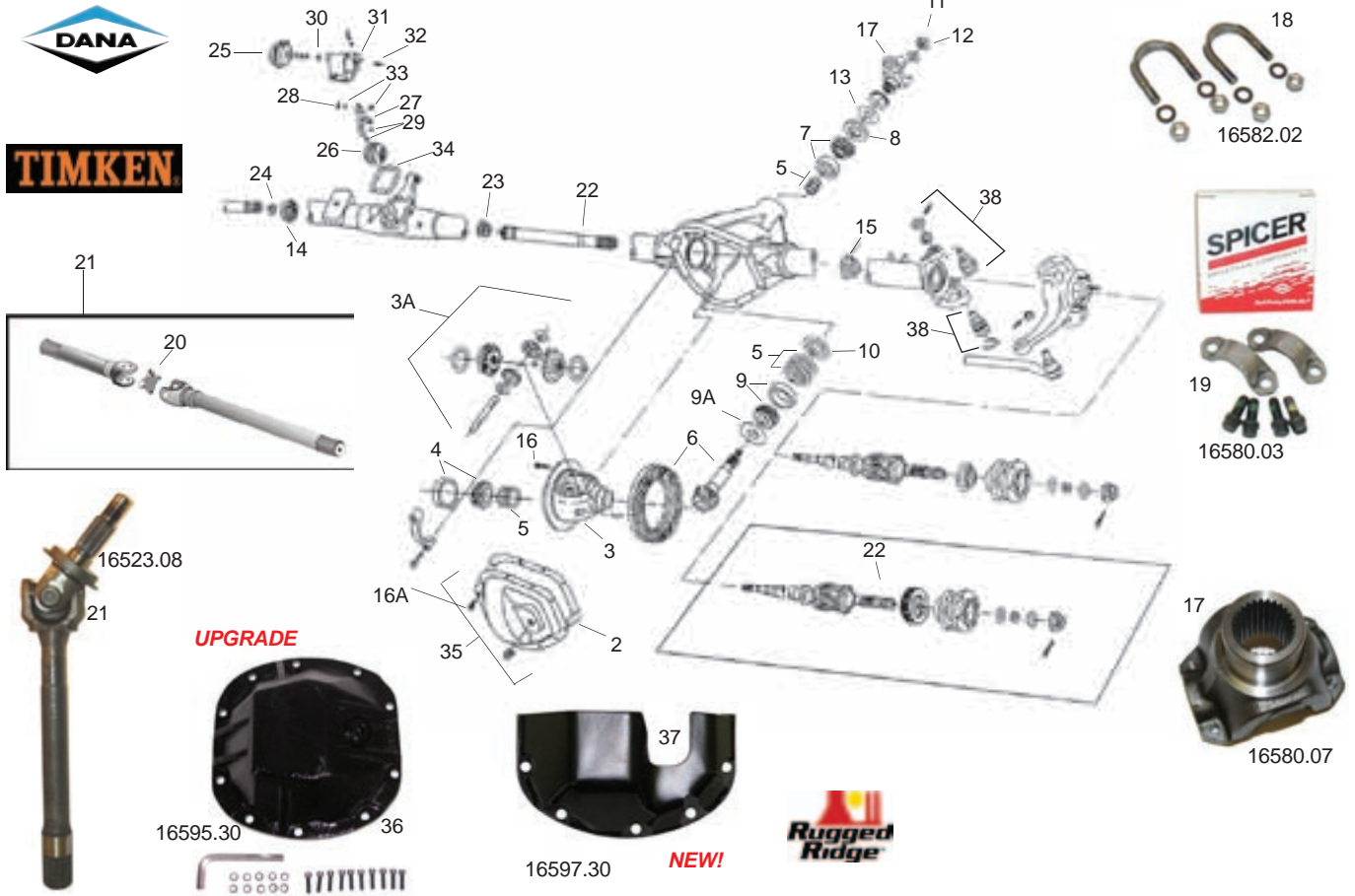

1987-95 WRANGLER & 1984-91 CHEROKEE FRONT DANA-30 WITH DISCONNECT

DESCRIPTION	Stock No.
1 REBUILD KIT (bearings, seal, shims & hardware)	16501.02
2 GASKET, FRONT AXLE COVER	16502.01
3 STANDARD DIFFERENTIAL CASE (w/ gasket, shims & ring bolts)	
W/ 2.73 TO 3.55 RATIO	16503.04
W/ 3.73 TO 4.56 RATIO	16503.05
3A SPIDER GEAR KIT STANDARD DIFFERENTIAL (w/ seal & bolts)	16507.03
3B CASE ASSEMBLY KIT STANDARD DIFFERENTIAL:	
1990-96, 3.07-3.55 RATIO, SPICER (item #3&3A)	16505.01
1990-96, 3.73-4.10 RATIO, SPICER (item #3&3A)	16505.02
1987-89, 3.07-3.55 RATIO, SPICER (item #3&3A)	16505.03
1987-89, 3.73-4.10 RATIO, SPICER (item #3&3A)	16505.04
4 BEARING KIT DIFFERENTIAL SIDE (2 bearings & 2 cups)	16509.05
5 SHIM SET KIT, FOR SIDE BEARINGS & PINION BEARINGS & HARDWARE	16512.02
6 RING & PINION KIT (w/ pinion bearings & cups, pinion nut & washer, oil seal & slinger, ring bolts, shim kit) (all ring & pinions are reverse rotation)	
3.07 RATIO (43X14 TEETH)	16513.20
3.54 RATIO (39X11 TEETH)	16513.21
3.73 RATIO (41X11 TEETH)	16513.22
4.10 RATIO (41X10 TEETH)	16513.23
4.56 RATIO (41X9 TEETH)	16513.24
4.88 RATIO (ring & pinion only, need separate rebuild kit)	16513.25
7 OUTER PINION BEARING KIT (1 bearing & 1 cup)	16517.01
8 OUTER PINION BEARING OIL SLINGER	16512.52
9 INNER PINION BEARING KIT (1 bearing & 1 cup)	16515.02
9A INNER PINION OIL SLINGER	16512.51
10 INNER PINION BEARING BAFFLE	16512.53
11 NUT, PINION	16584.01
12 WASHER, PINION	16584.02
13 OIL SEAL, PINION	16521.01
OIL SEAL, PINION-NATIONAL BRAND	16521.02
14 OIL SEAL, INNER SIDE OF THE AXLE, RIGHT	16526.03
15 OIL SEAL, INNER SIDE OF THE AXLE, LEFT	16526.02
16 BOLT FOR RING GEAR (each, 10 needed)	16522.01
16A DIFF COVER BOLT, DANA-30, 35, 44, & AMC-20	16522.02
17 YOKE, U-BOLT STYLE	16580.02
YOKE, STRAP & BOLT STYLE	16580.07
18 U-BOLT PAIR KIT FOR U-BOLT STYLE YOKE	16582.01
SPICER BRAND	16582.02

DESCRIPTION	Stock No.
19 STRAP & BOLT KIT FOR STRAP & BOLT STYLE YOKE	16582.03
20 U-JOINT KIT, LEFT OR RIGHT	
1987-94, GREASABLE,	16525.01
1987-94, GREASABLE, SPICER BRAND	16525.02
1987-94, NON-GREASABLE, SPICER BRAND	16525.03
1995, GREASABLE,	16525.04
1995, NON-GREASABLE, SPICER BRAND	16525.05
1995-UP, GREASABLE, SPICER BRAND	16525.06
21 AXLE SHAFT ASSEMBLY,	
OUTER PASSENGER SIDE 1987-95 W/O ABS	16523.08
OUTER PASSENGER SIDE 1990-95 W/ABS	16523.10
DRIVER SIDE, 1987-95 W/O ABS	16523.09
DRIVER SIDE, 1990-95 W/ABS	16523.11
22 AXLE SHAFT, INNER PASSENGER SIDE (all models)	16523.12
OUTER AXLE SHAFT, 1987-94 (w/o ABS), FITS LEFT OR RIGHT	16523.13
23 1987-89 INNER BUSHING BEARING	16527.05 TBA
1990-95 INNER BUSHING BEARING (w/o ABS)	16527.06
24 1987-89 OUTER BEARING	16527.07
1990-95 OUTER BEARING	16527.08
25 1987-90 AXLE DISCONNECT MOTOR ASSEMBLY	16527.09 TBA
1991-95 AXLE DISCONNECT MOTOR ASSEMBLY	16527.10
26 1987-95 AXLE DISCONNECT SHIFT FORK COLLAR	16527.11 TBA
27 1987-95 AXLE DISCONNECT SHIFT FORK	16527.12
28 1987-95 AXLE DISCONNECT MOTOR RETAINING CLIP	16527.13
29 1987-95 AXLE DISCONNECT SHIFT FORK INSERT	16527.14
30 1987-95 AXLE DISCONNECT SERVO RING	16527.15 TBA
31 1991-95 AXLE DISCONNECT HOUSING COVER	16527.16 TBA
32 1991-95 AXLE DISCONNECT SWITCH ASSEMBLY	16527.17 TBA
33 1987-95 AXLE DISCONNECT SHIFT FORK SNAP RING	16527.18
34 1987-95 AXLE DISCONNECT HOUSING COVER GASKET	16527.19
35 DIFFERENTIAL COVER KIT STAINLESS STEEL INCLUDES GASKET & BOLTS	11118.01
36 HEAVY DUTY DIFFERENTIAL COVER, 3/8" THICK CAST STEEL, W/ HARDWARE (UPGRADE)	16595.30
37 HEAVY DUTY DIFFERENTIAL SKID PLATE, 3/8" THICK CAST STEEL, W/ HARDWARE (UPGRADE)	16597.30
38 BALL JOINT KIT (upper & lower w/ hardware)	18036.02